



i User Instructions
LKEM-REX-04
 LED Emergency Exit Box



Please read these instructions and retain them for future reference.

Important information:

It is recommended that this fitting is installed by a qualified electrician ensuring the installation complies with current IEE wiring regulations & local building control.

- This product is designed for connection to a 220-240V mains supply.
- This product is for indoor use only.
- We cannot accept responsibility for any claims arising from a poor installation.
- Always switch off mains supply before installation.
- The light fitting is Class II and does not require an earth connection.

Technical Specifications:

- Input Voltage: 220-240V/AC
- Power: 4W
- Light Output: 38Lm (charging)
48Lm (discharging)
- Viewing Distance: 30m max.
- CCT Temp.: 6500K
- IP Rating: IP20
- Protection Class: Class II
- Housing: PC Body & Acrylic Lit Panel
- Wall Mounting
- Battery: NiCd 3.6V 1400mAh
- 4 Legends included
- Warranty: 5 years (excluding battery)

Dimensions:

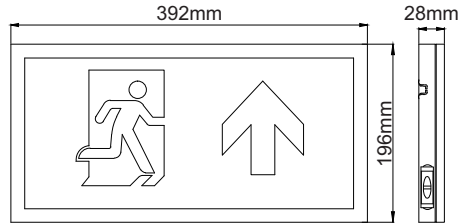

Installation and Wiring Instructions:

1. Switch off the mains supply.
2. Open the exit box by moving the two side sliders into "OPEN" position and open the front case.

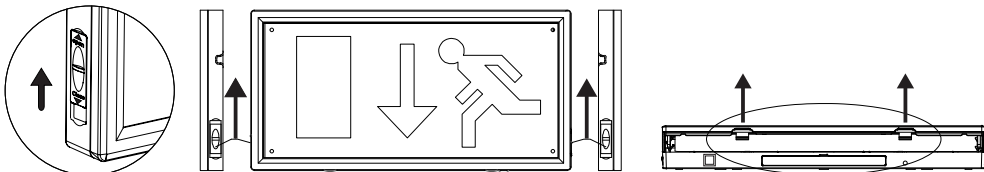

3. The LKEM-REX-04 exit box can be mounted on surfaces using the two installation holes. First mark the hole positions, feed the cable through the back of the fitting and use the screws provided to mount the back plate on the surface.
4. Connect the battery to the PCB and write the installation date on the battery.

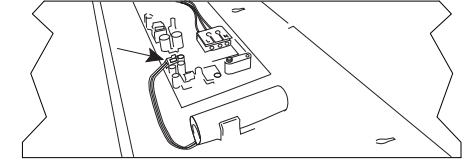
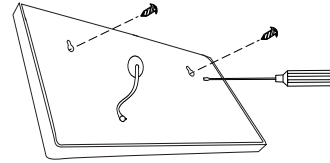

5. Connect the mains supply to the connection block as per the wiring diagram below observing the correct polarity.

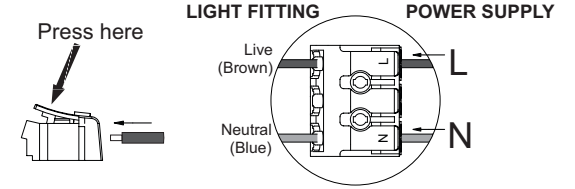
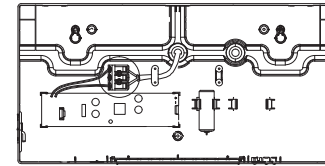

6. Close the front cover by moving the two side sliders into "CLOSE" position and secure using the 2 screws provided.

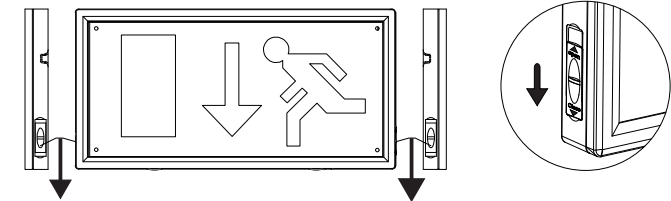

Replacing the legend:

Unclip the tabs on the sides of the top cover and pull out the legend holder. Replace the legend and fix the legend cover back into place.

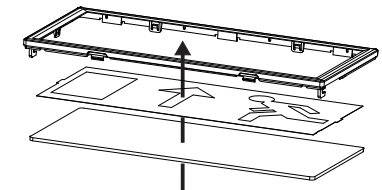
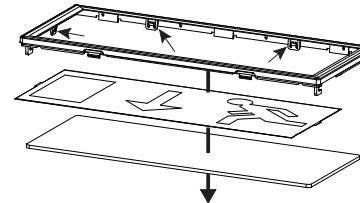

Testing Instructions:

- Emergency light fittings must be inspected and tested regularly in accordance with local codes of practice. For safety reasons, tests should be carried out during daylight hours.
 - The minimum recommended test schedule is as follows:
After installation, allow minimum 24 hours to ensure full battery charge. Then interrupt the supply and check after 3 hours that the fitting is still illuminated.
1. Daily check that the charge indicator LED is working
 2. Every month, interrupt mains for a short period and check that fitting lights
 3. Six-monthly, check 1 hour duration
 4. At the end of year 3 and subsequently every year, check 3 hour duration: batteries must be replaced when they can no longer support 3 hour duration
 5. Complete the record sheet on installation and retain in a maintenance file
 6. Update the file with ongoing test records for inspection by a fire officer or other duly authorised person

Maintenance:

- Check power cable and housing of the fitting for damage before use. If the diffuser is damaged, unit must be replaced immediately.
- Clean any dirt from the housing or the diffuser immediately, it could potentially cause overheating.

