

US-CL4W



2.2W Ultra Slim LED Cabinet Light Set 4pcs.

Please read these instructions and retain them for future reference.

Important information

It is recommended that the fittings are installed by a qualified electrician ensuring the installation complies to current IEE wiring regulations & local building control.

We cannot accept responsibility for any claims arising from a poor installation.

Important User Advice

- Always switch off mains supply before installation.
- The fitting is suitable for indoor use only.
- This product is Double Insulated and does not require connection to an Earth circuit.
- This system operates at Safety Extra Low Voltage (12V), via a LED power supply.
- Never connect the light fittings directly to the mains.
- Do not exceed the LED power supply load - a maximum of 6 lights can be connected with the 18W power supply included.

Components and Structure:

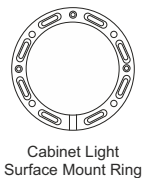
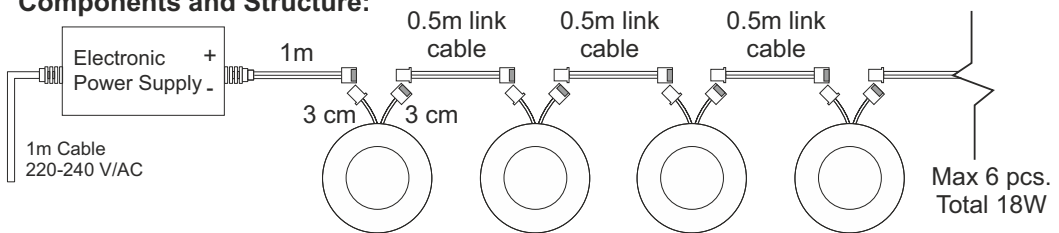

Cabinet Light Surface Mount Ring

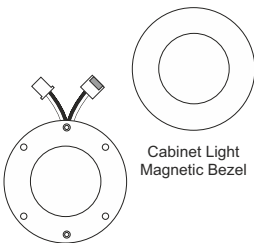

Cabinet Light Magnetic Bezel

Cabinet Light with Male & Female Connector

Dimensions:

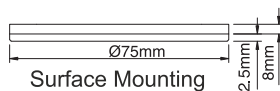

Surface Mounting

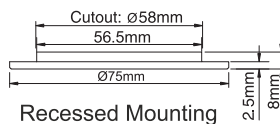

Recessed Mounting

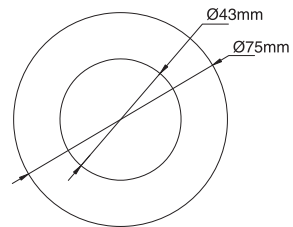

Specifications:

- Nominal Power: 2.2W/light
- Power Adapter Max Load: 18W
- Up to 6 Cabinet lights can be installed in series using supplied adapter
- Lumen Output: 180lm/light
- Beam Angle: 110°
- CRI(Ra): 80
- LED Colour: 4000k Cool White
- IP Rating: IP44
- 2 Year Warranty
- Operation Temp: Max Ta=45°C

- Housing Material: High Quality Heat Conductive Plastic
- White Magnetic bezel included
- Cabinet lights complete with male and female connectors
- Surface or Recess Mount

Package includes:

- Ultra slim Cabinet Lights with male & female connectors x 4pcs
- 18W 220-240VAC LED Driver x 1pc
- 3M sticky pads for surface mounting x 4pcs
- Mounting screws x 8pcs
- 0.5m 12V supply cable x 3pcs
- 1m 12V supply cable x 1pc

Installation: ⚠ **Warning!** Switch off the power source before installation & maintenance

RECESSED INSTALLATION:

1. Determine the position of your cabinet light(s) and trace a 58mm diameter circle on surface material. Using a keyhole saw or 58mm drill bit - cut hole (Fig. 1).
2. Feed the connectors through the hole and join them to the 12V supply cable. Screw the cabinet light into surface using the two screws (supplied) (Fig. 2).
3. Connect 12V supply cable to power feed and snap the magnetic bezel to the cabinet light (Fig. 3).
4. Turn ON power to test for correct operation.

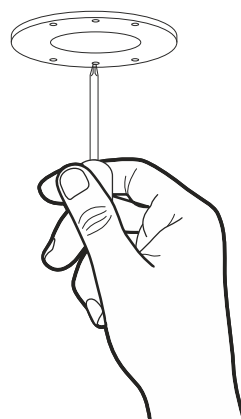
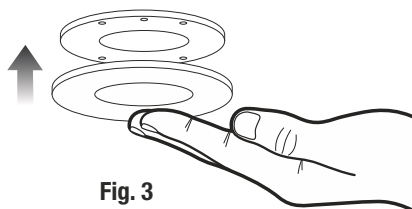
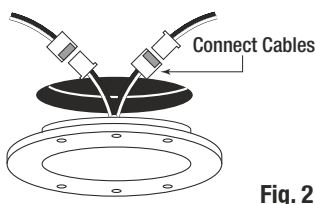
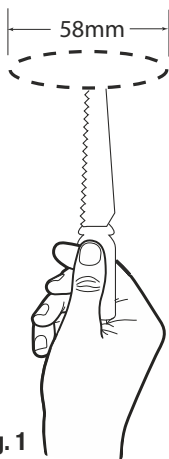

SURFACE INSTALLATION:

1. Determine the position of your cabinet light(s) and position cabinet light surface mount ring.
- 2a. Clean the surface; use the 3M sticky pad (supplied) and paste it to the bottom of the cabinet light. Place the light in the required position and press to stick.
- 2b. Screw surface mount ring onto surface (Fig. 4) at the required position.
3. Making sure that you insert feed cables through surface mount ring wire slot, position cabinet light onto surface mount ring. Ring is held magnetically (Fig. 5).
3. Connect 12V supply cable to power feed and snap the magnetic bezel to the cabinet light (Fig.3).
4. Turn ON power to test for correct operation.

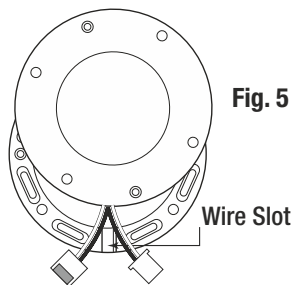
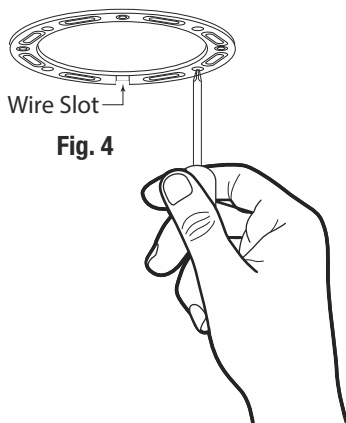

Accessories available (sold separately):
US-CL1W - 2.2W Ultra Slim LED Cabinet Light 4000K
US-CLC09M - 0.5m Linking Cable with Connectors
US-CLD - 1m Linking Cable with Connectors

NOTE: Cabinet lights are mounted in series. The 18 watt power supply can feed up to 6 Ultra Slim Cabinet lights.