

LEDTEK® ⓘ Installation Sheet

21W GALAXY LED - GALAXY 21 IP54 DECORATIVE ROUND BULKHEAD

CE 220-240V



These instructions should be read carefully and retained after installation for further reference and maintenance.

SAFETY

- Before installation, ensure that the mains supply to the luminaire is switched off and the circuit supply fuse is removed or MCB turned off.
- It is recommended that a qualified electrician is consulted or used for the installation of this luminaire and it is installed in accordance with the IEE wiring regulations.
- Check that the total load on the circuit, including this luminaire, does not exceed the rating of the circuit cable, fuse or MCB.

RATINGS

- This luminaire is of class II construction and does not require an earth connection.
- IP54 rated.
- F marked, suitable for installation on normal flammable surfaces.
- Ambient temperature: -20°C to 40°C.
- 220-240V AC rated.
- CE Approved.

INSTALLATION

- Remove the trim by twisting 45 degrees anti-clockwise and undo the 3 screws to release the diffuser. The screws are self retaining.
- The gear tray is hinged to allow easy access to the connections. Open the gear tray for access to the cable connections.
- Select a suitable cable entry point provided or by drilling into the base.
- Position and fix the base to a suitable solid surface using screws supplied.
- Enter supply cable into the luminaire ensuring that the hole is smooth or a grommet is fitted.
- Terminate the cable into the terminal block mounted on the underside of the gear tray ensuring correct polarity is observed and any bare conductors are sleeved.
- Close the hinged gear tray.
- Re-fit the diffuser by screwing the 3 screws back into the base. Place the trim back on top and turn 45 degrees clockwise to lock in to place.

IMPORTANT – WHEN REPLACING OR FITTING THE LED GEAR TRAY ENSURE THE POWER IS SWITCHED OFF.



21W GALAXY LED - GALAXY 21 IP54 DECORATIVE ROUND BULKHEAD

These instructions are in addition to the standard luminaire instructions that were supplied with the product you have purchased. Please read them carefully and install the luminaire as per instructions, then keep the instructions for future reference and maintenance.

IMPORTANT SAFETY INFORMATION

THIS PRODUCT MUST BE INSTALLED IN ACCORDANCE WITH ALL APPLICABLE INSTALLATION CODES.

INSTALLATION

1. The luminaire should be installed as instructed in the Instructions sheet supplied.
2. BE SURE POWER IS TURNED OFF AT THE MAIN POWER PANEL OR FUSE BOX PRIOR TO INSTALLATION OR REPLACING THE LUMINAIRE.
3. It is recommended that luminaires are installed by a qualified electrician ensuring the installation complies to current IEE wiring regulations & local building control.
4. This sensor is to be connected to a 230±10% volt, 50 or 60 Hz power source. Connecting to a different power source may create a hazard and will void the warranty.
5. Do not attempt to open the unit housing. There are no serviceable parts inside.
6. We will not accept responsibility for any claims arising from a poor installation.

High Environmental Adaptability

The microwave motion sensor has high reliability, it's detection range is less affected by temperature, wind, airflow, sound, light, fog, smoke, dust, etc.

High Sensitivity for Occupancy Detecting

This product can detect the slightest movement, such as lifting an arm, turning round, stooping etc. In addition, unlike infrared sensor, the microwave sensor has no directional characteristics. Movement in any direction can be detected.

Wall Mounting Coverage

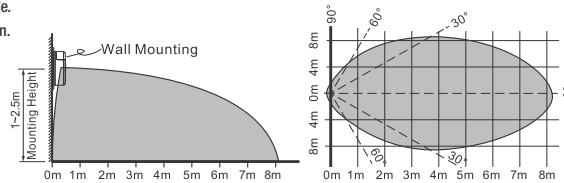

Ceiling Mounting Coverage

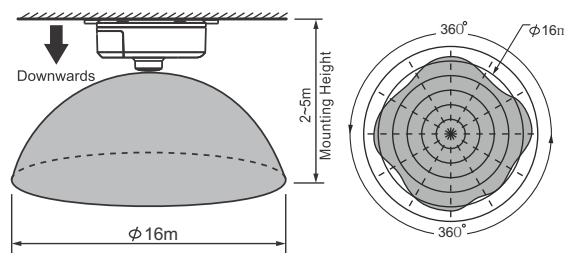

TECHNICAL PARAMETERS

RATING	230±10% VAC 50/60Hz
INSTALLATION	Wall / Ceiling
MICROWAVE FREQUENCY	5.8GHz ± 75MHz CW RADAR, ISM BAND, TRANSMITTER POWER < 0.2mW
MOUNTING HEIGHT	2-5M Ceiling / 1-2.5m Wall
DETECTION ANGLE	360 DEGREES (CEILING MOUNTING)
DETECTION DISTANCE	ø16m Ceiling Mount & 8m Wall mount
AMBIENT CONTROL	10 Lux ~ 2000 Lux (ADJUSTABLE)
TIME DELAY	10 sec ~ 30 MINUTES
STANDBY POWER	Approx 0.9W
RATED LOAD	1200W Incandescent (220VAC, cosφ=1) 300W Fluorescent (220VAC, cosφ=0.5) 200W LED Lamps
OPERATING TEMPERATURE	0 ~ +60°C @ FULL LOAD; +70°C @ 60% LOAD
STORAGE TEMPERATURE	-20 ~ +80°C, 10-95% RH

PRODUCT SIZE

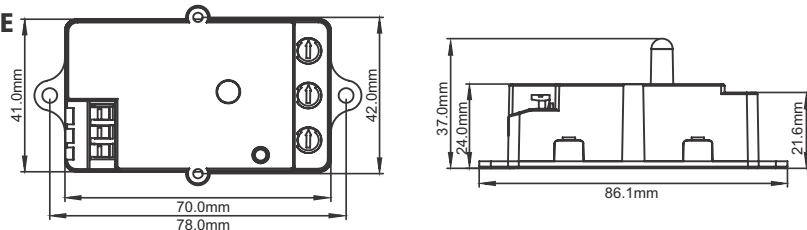

SETTING THE SENSOR

The sensor has three adjustments to control the fitting, which can be automatically turned ON or turned OFF according to setting value.

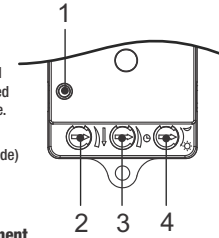

1. Ambient illumination detector (Photodiode) & Flash LED

2. Sensitivity setting knob



Sensitivity Adjustment

For minimum sensitivity turn the knob anticlockwise, for maximum sensitivity turn fully clockwise. Minimum sensitivity detects up to 2m. Maximum detection is up to 16m.

3. Time setting knob



Time adjustment (1-30 Minutes)

The TIME adjustment controls how long the fitting will stay on after motion is no longer detected.

When the light is switched ON the Flash LED in the Photodiode (1) will indicate the time setting:
1 flash = 10sec, 2 flashes= 1 min, 3 flashes= 2 min, 4 flashes= 5 min, 5 flashes=8 min, 6 flashes=10 min, 7 flashes=15 min, 8 flashes=20 min, 9 flashes=25 min, 10 flashes=30 min.

4. Lux setting knob



LUX Level*

The LUX adjustment determines at what level the sensor will start operating when set to automatic operation & can be adjusted to suit individual requirements.

* On the **corridor function** model please set the lux level to full daylight for the fitting to function efficiently.

Warm-up:

This unit requires a warm-up of approx. 10 seconds after power is applied for the system's circuit to stabilize.

Warning!

The product can not work normally if there is metal material in front of the installation place.

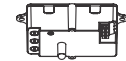

Non-metal material

When the sensor is installed inside the ceiling floor, the sensitivity to light will be invalid.

Manual Override:

(LED indicator - Interval 1 second flash 1 time)

Turn the switch OFF then ON once within 2 seconds. This will activate the manual override facility. The sensor will reset to automatic mode after 4 hours.

To return to automatic mode within the 4 hours turn the switch OFF then ON again within 2 seconds.

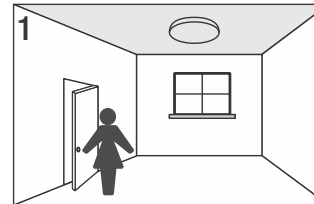

Sensor prevents activation during daylight hours.

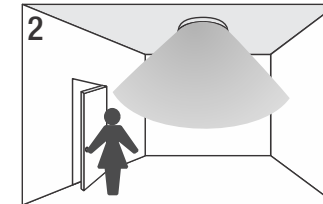

During darkness the sensor detects movement in the room and turns the light on.

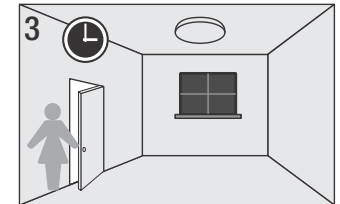

Once movement is no longer detected the sensor will turn the light off after the pre-set time.

TROUBLESHOOTING

Q1: Does not function at all

- Make sure the power switch (if applicable) is ON and check the wiring is correct.
- Check that the circuit breaker, fuse, and main circuit breaker or main power switch are ON.
- Should the light level be too bright it may be necessary to increase the LUX setting.

Q2: The sensor light is always ON

- Movement occurred, but not identified by the sensor (movement behind wall, movement of a small object in immediate lamp vicinity etc.)