

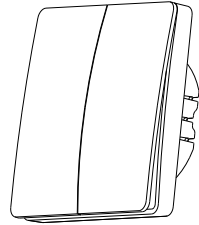

Kinetic In-Line Receiver Switch



Installation Instructions



Self Powered No Radiation No Maintenance No Wiring Durable Cost Saving

Read instructions carefully before installation

Specifications

- Switch Type:** Push button switch
 - Number of keys:** 1-2 keys
 - Power mode:** Single Live Line Power Supply
 - Rated Power:** 600W LED /circuit
900W other loads*/circuit
 - Working Voltage:** 220-240V/AC 50/60Hz
 - Operating frequency:** 433MHz
 - Lamp Load Minimum Power:** 5W
 - Working Temperature:** -20°C ~ +55°C
 - Control distance**:** 80m (outdoor) 25m (indoor)
 - Control Method:** Pairing with Kinetic Switches
 - Simply replace your existing wall switch with a Kinetic Live Line switch
 - Combines wall switch with wireless controller
 - Fits into 25mm metal/plastic patress
 - Each switch/controller can pair with a maximum of 5 auxiliary Kinetic switches
- Warranty:** 3 Years

*Maximum load rating may vary depending on manufacturers specifications.
**Distance comes from Quinetic laboratory test result. The actual distance in practical use might vary due to environmental difference.

Available Models

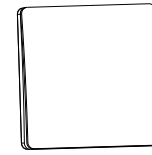

1 Gang White
KRS1W

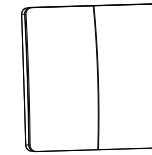

2 Gang White
KRS2W

EveryKinetic product has passed a strict quality inspection before it leaves the factory. Kinetic provides 3 years warranty if installed & used in accordance with these instructions. Within the 3 years warranty period, Kinetic will be responsible for the repair, free replacement of parts or entire product.

In-Line Receiver Switch Installation

1. Ensure that the power is turned off before installation.
 2. The In-Line receiver switch line input should be connected using only the **Live cable** from mains.
- ATTENTION!** - If a neutral line is in situ do not connect it to the In-Line Switch - this might result in damaging the product! The In-line receiver switch only works when you have a live feed in and a live feed out.

3. Remove the existing switch from the wall (Fig.1).

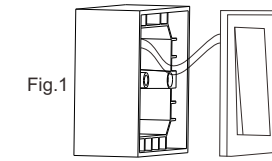
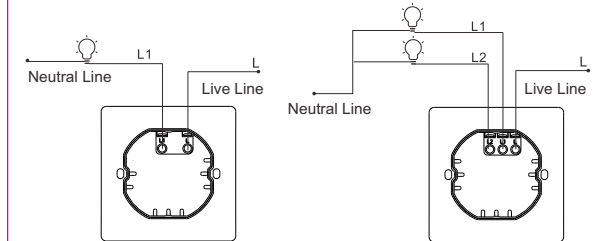

Fig.1

4. Disconnect the existing Live in / Live feed out from the existing wall switch and connect the same to the In-Line receiver switch as per the wiring diagrams below (Fig.2):



KRS1W

KRS2W

Fig.2
Wiring Diagram

5. Carefully open the switch panel as shown in the figure below (Fig.3) and fix the switch back into place on the wall box.

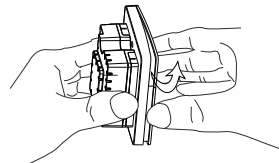
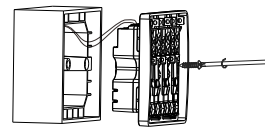

Fig.3 Carefully open the switch panel

Fig.4 Fix the switch on the wall box



6. Press the switch panel back onto the base (Fig.5)

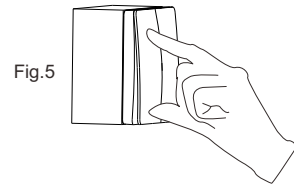
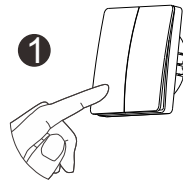

Fig.5

In-Line Receiver Switch Pairing

The Kinetic In-Line Switch pairs with Kinetic wireless switches for dual or multiple control. A **maximum of 5 switches** can be paired with a In-line circuit.

Press and hold the switch for 6 seconds until the connected lights start to flash. Release the switch - the live line switch is now in pairing mode. Press the wireless switch button you want to add to pair it.



In-Line Switch

Press and hold the switch 6 seconds

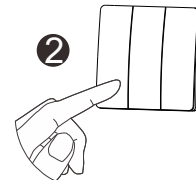

Kinetic Wireless switch

Press the wireless switch button once to pair it with the In-Line switch

To **unpair** the auxiliary switches simply press the switch for 12 seconds until the lights connected to the switch flash 3 times and stop flashing. All the pairing information is now cleared.

Press and hold the switch 12 seconds to unpair

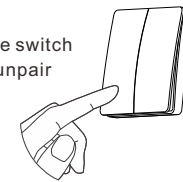

Precautions

Do not connect the Neutral wire to the In-Line switch - this might damage the product!

Troubleshooting

If the light is weak or flashes continuously after the switch is installed it means that the lamps/load is under 5W.

The In-Line receiver switch does not support lamps/loads under 5W. Please replace the lamps with one of 5W or above.

Dimensions

