

200mm/250mm ES Globe Light Fittings



Please read these instructions before commencing installation & retain them for future reference.

Important information

- Electrical products can cause death, injury or damage to property. If in any doubt about the installation or use of this product, consult a qualified electrician.
- Globes are supplied complete with base and lamp holder.
- For indoor and outdoor use.
- Any broken or damaged parts should be replaced as soon as possible.
- We will not accept responsibility for any claims arising from a poor installation.

Specifications:

- Material: PMMA UV Resistant
- Diameter: FE6000FU/P/TR - 200mm
FE6001FU/P/TR - 250mm
- IP Rating: IP44
- Class II
- Finishes: Smoke, Opal, Clear
- Lamp holder: ES (E27)
- FE6000FU/P/TR Lamp max 40W, 140mm height
- FE6001FU/P/TR Lamp max 60W, 190mm height
- Accessories available: 3 Types of wall fixing brackets, poles, top pole bracket and waterproof gasket.

Installation Instructions:

- Ensure mains supply is switched OFF.
- Connect mains supply cables ensuring Live and Neutral polarities are observed: Brown = Live (L) and Blue = Neutral (N) (1).
- Remove the globe cover by turning it anti-clockwise (2).
- Fit lamp into the lamp holder (3).
- Secure the fitting in place by tightening the base screw (4).
- Re-fit the globe cover by turning it clockwise (5).
- Switch the mains supply ON and test the fitting.

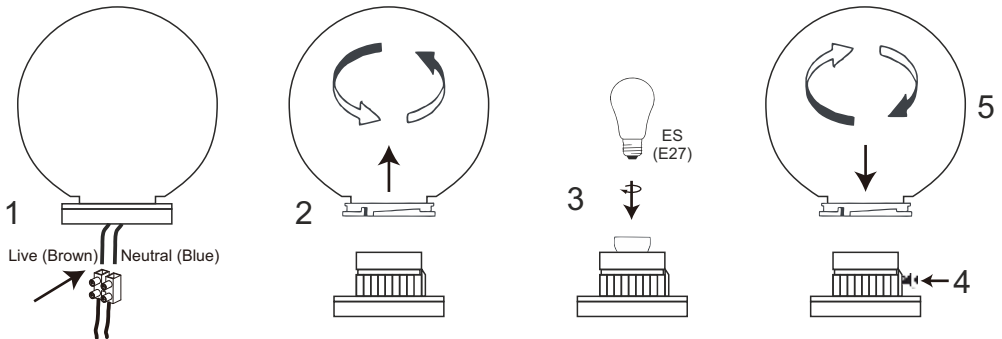

Information for the Product User:

1. Please note the requirement to dispose of Waste Electrical & Electronic Equipment separately from household waste (WEEE marked with crossed out wheelie bin symbol).
2. Please consider your role in contributing to re-use and recycling by returning this product at end of life to a collection centre for waste electrical equipment.
3. This equipment may contain substances that are hazardous to health and the environment if disposed of carelessly. It is important that it is separated from normal household waste and recycled in the WEEE chain.
4. The "crossed out wheelie bin symbol" on a product indicates this equipment must not be disposed of in normal household waste, but should be disposed of according to local WEEE regulations (European "WEEE Directive" effective August 2005—UK WEEE Regulations effective 2nd January 2007).

